

IV

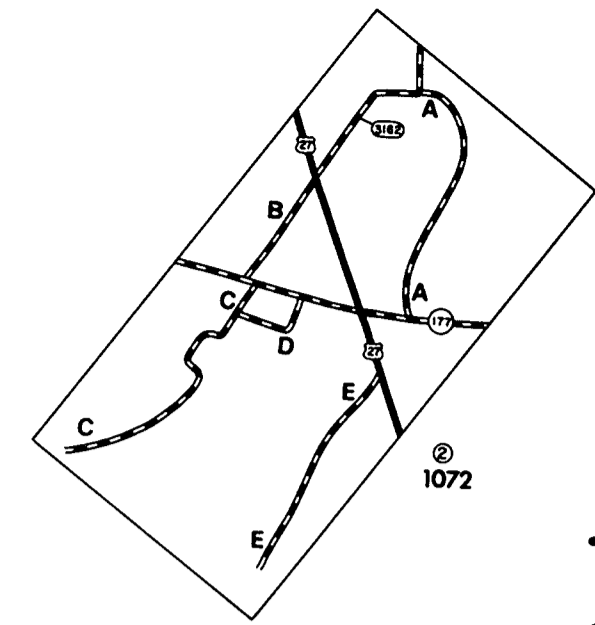

I

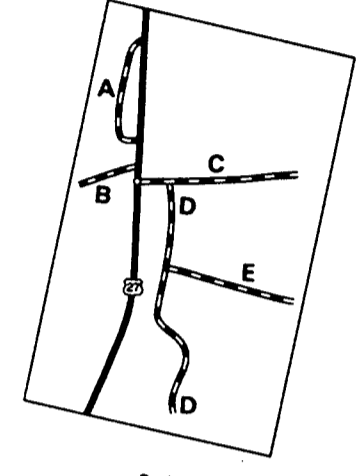
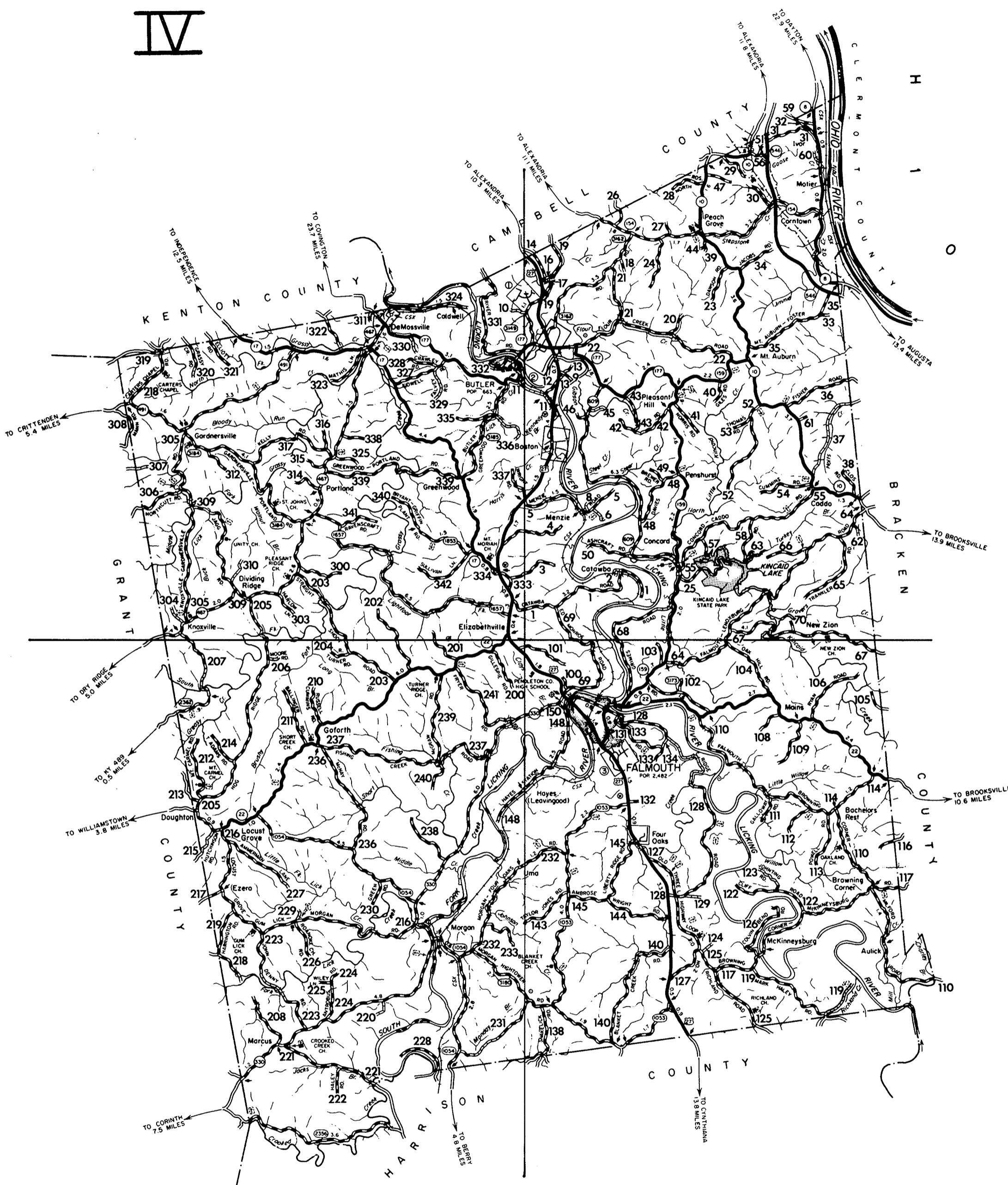

Boston  
1007

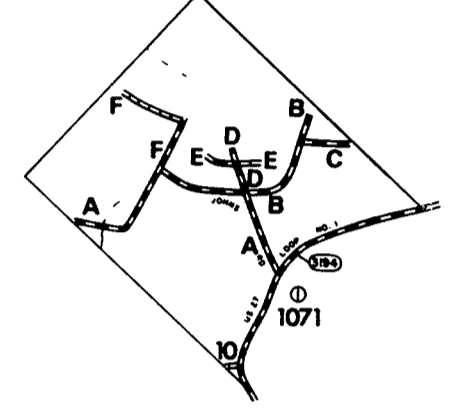

1071

III

II

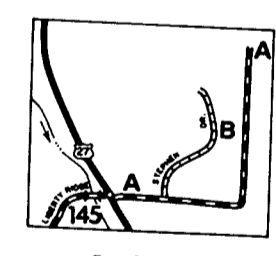

Four Oaks  
1152

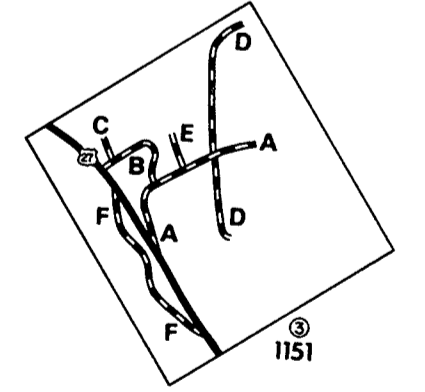

1151

SHEET 1 OF 2

1990

COUNTY ROAD SERIES MAP  
**PENDLETON COUNTY**  
 KENTUCKY

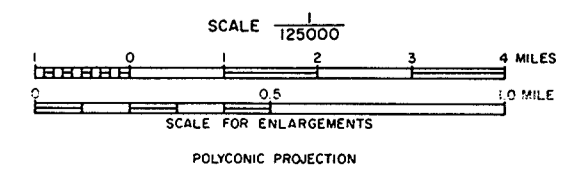

DATE APPROVED BY FISCAL COURT 1-25-1990

QUADRANT I

QUADRANT II

QUADRANT III

QUADRANT IV

NO.	ROAD NAME	LGTH.	NO.	ROAD NAME	LGTH.	NO.	ROAD NAME	LGTH.	NO.	ROAD NAME	LGTH.
1001	CATAWBA	4.20	1100	OLD THREE "L" HIGHWAY LOOP NO. 1	0.10	1200	GILLESPIE	1.10	1300	CAHILL	1.15
1002	CATAWBA SPUR	0.15	1101	GEORGE KING	0.85	1201	AIRPORT	1.00	1301		0.00
1003	TAIL POINT	1.25	1102	KLEE	0.25	1202	DAHMS	1.80	1302		0.00
1004	BLACKBURN	1.55	1103	HOLMES	0.55	1203	STRAIGHT SHOOT	3.65	1303	HARLOW	0.65
1005	MENZIE	2.65	1104	OAK HILL	1.65	1204	R. TURNER	0.45	1304	ROBERTSON	0.35
1006	ACKMAN	0.35	1105	WEST	0.25	1205	HOGG RIDGE	6.05	1305	KNOXVILLE - GARDNERSVILLE	4.95
1007	STREETS IN BOSTON		1106	RYAN	1.20	1206	MOORE LANE	0.20	1306	NORTHCUTT	1.15
A	PEOPLES	0.25	1107		0.00	1207	FAIRVIEW	1.80	1307	RUSSELL FLYNN	0.20
B	BALL STREET	0.15	1108	CORDRAY	0.65	1208	OLD CYNTHIANA SOUTH	1.35	1308	MANN	0.20
C	BRADFORD	0.30	1109	MILLER	1.25	1209		0.00	1309	JAGG	2.75
D	FUQUA LANE	0.40	1110	FALMOUTH - BROWNINGS - CORNER - MILFORD	10.35	1210	RUSSELL CUMMINS	0.90	1310	OAKS	0.45
E	BURLEW	0.20	1111	GALLOWAY	0.60	1211	BALLINGER	1.40	1311	NEAL	0.20
1008	RUBER	0.20	1112	PALESTINE	0.75	1212	MOUNT CARMEL	1.40	1312	BROWNFIELD	0.60
1009	INDUSTRIAL PARK	0.35	1113	POWELL	1.30	1213	BRANU LANE	0.20	1313		0.00
1010	J. GOSNEY	0.45	1114	BACHELORS REST	1.26	1214	T. ADAMS	0.65	1314	STRAUB LANE	0.75
1011	HOGBACK RIDGE	1.00	1115		0.00	1215	HUTCHINSON	0.55	1315	SPONCIL	0.45
1012	DAYS	0.50	1116	BROWNING - CORNER NEAVE	0.30	1216	LOCUST GROVE - GUMLUCK - MORGAN	7.05	1316	SCHLUETER	0.45
1013	VALLEYVIEW LANE	0.40	1117	BROWNING - CORNER - MCKINNEYSBURG	5.50	1217	ATHA LANE	0.30	1317	KELLY	2.50
1014	BOSS DUNNAWAY	0.60	1118		0.00	1218	OLD CYNTHIANA NORTH	0.55	1318	CARTERS CHAPEL	1.45
1015		0.00	1119	MARK HALEY	3.05	1219	HARRINGTON	1.10	1319	ROGERS	0.25
1016	CEDAR	0.25	1120		0.00	1220	HARDIN SOUTH	0.35	1320	GRASSY CREEK	0.80
1017	CEDAR LANE	0.10	1121		0.00	1221	JACKS BRANCH	2.35	1321	ELLIOTT	0.50
1018	VIERS	0.25	1122	CLIFF	1.95	1222	HALEY	0.70	1322	DE MOSSVILLE	0.80
1019	OLD US 27 LOOP NO. 2	1.45	1123	JOHNTING LANE	0.75	1223	JOHN DENNY	2.80	1323	MATHIS LANE	1.10
1020	HALE	0.45	1124	COLVIN WEST	0.30	1224	ANTROBUS	1.20	1324	DE MOSSVILLE - CALDWELL	1.60
1021	VATER	1.35	1125	RICHLAND	2.20	1225	WILEY LANE	0.30	1325	SMITH	0.45
1022	FLOUR CREEK	4.30	1126	COLVIN BEND	1.85	1226	ROANOKE CHURCH	0.85	1326	STREETS IN DE MOSSVILLE	
1023	DAWSON LANE	0.23	1127	OLD THREE "L" HIGHWAY LOOP NO. 2	3.75	1227	AMMERMAN LANE	1.80	A	BACK STREET	0.15
1024	GARVEY	1.30	1128	BISHOP RIDGE	7.05	1228	OSCAR SPRADLING	0.90	B	DE MOSSVILLE STREET	0.35
*1025	KINCAID LAKE STATE PARK	1.50	1129	COLVIN	0.35	1229	AMMERMAN SOUTH	0.25	1327	KIDWELL	1.35
1026	NEWKIRK	0.40	1130		0.00	1230	GREEN	0.60	1328	CROWLEY	0.65
1027	LITTLE PLUMMER SOUTH	0.70	1131	RESERVOIR	0.10	1231	JONESTOWN	2.35	1329	FALVEY	0.60
1028	LITTLE PLUMMER NORTH	0.90	1132	HAMMER DRIVE	0.25	1232	MORGAN FOUR OAKS	4.00	1330	LEMONS	0.30
1029	MAYS	0.80	1133	MARQUETTE	1.45	1233	WEST KELLY	0.65	1331	RIVER	2.90
1030	STEPSTONE CHURCH	0.70	1134	MARQUETTE SPUR	0.35	1234		0.00	1332	OLD GRASSY CREEK PIKE	0.30
1031	BARKER EAST	1.35	1135		0.00	1235		0.00	1333	BETHEL LOOP	0.50
1032	IVOR SPUR	0.15	1136		0.00	1236	MCNAY	2.85	1334	BETHEL CHURCH	0.15
1033	NEW HOPE SPUR	0.20	1137		0.00	1237	FISHING CREEK	4.80	1335	CHESTER CAMPBELL	0.95
1034	JACOBS LANE	0.65	1138	SNAKE LICK	1.25	1238	GODMAN	1.10	1336	KATIE CAMPBELL	0.70
1035	MOUNT AUBURN FOSTER	2.40	1139		0.00	1239	MCGRAN	2.15	1337	WRIGHT	0.70
1036	FISHER	2.10	1140	BLANKET CREEK	3.10	1240	WOLFE	0.75	1338	HAFER	0.55
1037	HOLTS CREEK	2.05	1141		0.00	1241	FRYER	2.35	1339	GREENWOOD - PORTLAND	3.60
1038	CLOS	0.25	1142		0.00				1340	BRYANT GRIFFIN PLANT	1.25
1039	COLONY	0.30	1143	TAYLOR JONES	1.20				1341	RAVENS CRAFT	0.80
1040	GILES	0.45	1144	AMBROSE WRIGHT	1.60				1342	SULLIVAN	1.35
1041	NORRIS	0.90	1145	LIBERTY RIDGE	2.65				1343		0.00
1042	PRIBBLE	1.55	1146		0.00						
1043	IRA MARSHALL	1.00	1147		0.00						
1044	COLONY SPUR	0.05	1148	HAYES STATION	3.55						
1045	MOUNT HOPE EAST	0.35	1149		0.00						
1046	MOUNT HOPE WEST	0.20	1150	STEWART LANE	0.25						
1047	UPPER STEPSTONE	0.55	1151	STREETS IN ENLARGEMENT NO. 3							
1048	DAVIES	1.60	A	SOUTHSIDE CHURCH	0.35						
1049	BREWER	0.40	B	CHAD	0.15						
1050	ASHCRAFT	1.00	C	ABBNEYWOOD DRIVE	0.10						
1051	BARKER WEST	0.60	D	RHONDA DRIVE	0.75						
1052	HICKORY GROVE	2.30	E	CHAPMAN COURT	0.10						
1053	THOMAS	0.45	F	OLD US 27 LOOP NO. 6	0.35						
1054	CUMMINS - MOFFORD	1.30	1152	STREETS IN FOUR OAKS							
1055	CONCORD - CADDO	4.45	A	JENKINS LANE	0.60						
1056	BARKER SPUR	0.25	B	STEPHENS DRIVE	0.20						
1057	WATTS LANE	0.50									
1058	BONAR	1.00									
1059	IVOR	0.55									
1060	LOWER IVOR	0.30									
1061	COX LANE	0.25									
1062	GOFFMAN	0.30									
1063	LAKESIDE DRIVE	0.30									
1064	FALMOUTH - LENOXBURG	6.85									
1065	FRANKLER	2.00									
1066	SHARP	0.65									
1067	NEW ZION	4.20									
1068	GRIMES	3.40									
1069	ED MONROE	3.50									
1070	FROST	0.20									
1071	STREETS IN ENLARGEMENT NO. 1										
A	JOHNS	0.55									
B	OAK	0.35									
C	WALNUT	0.20									
D	CHERRY	0.15									
E	MAPLE	0.10									
F	SANDY BRANCH	0.30									
1072	STREETS IN ENLARGEMENT NO. 2										
A	LOCK	0.50									
B	NEW LOCK CONNECTOR	0.15									
C	MADER	0.45									
D	EAST SIDE PARK	0.25									
E	CATRONS CAMP	0.40									

\*ROAD NOT COUNTY MAINTAINED

SHEET 2 OF 2

1990  
 COUNTY ROAD SERIES MAP  
 PENDLETON COUNTY  
 KENTUCKY